



16 HORAS

Perfect after-sales service system 16 hours Online customer service to solve quality problems at any time

FREE ACCESSORIES

Dealer buys excavator and gets accessories

OEM

Support customization, create personalized service, make your excavator unique





SKID STEER

RS03

SKID STEER LOADER



HIGHLIGHTING ADVANTAGES

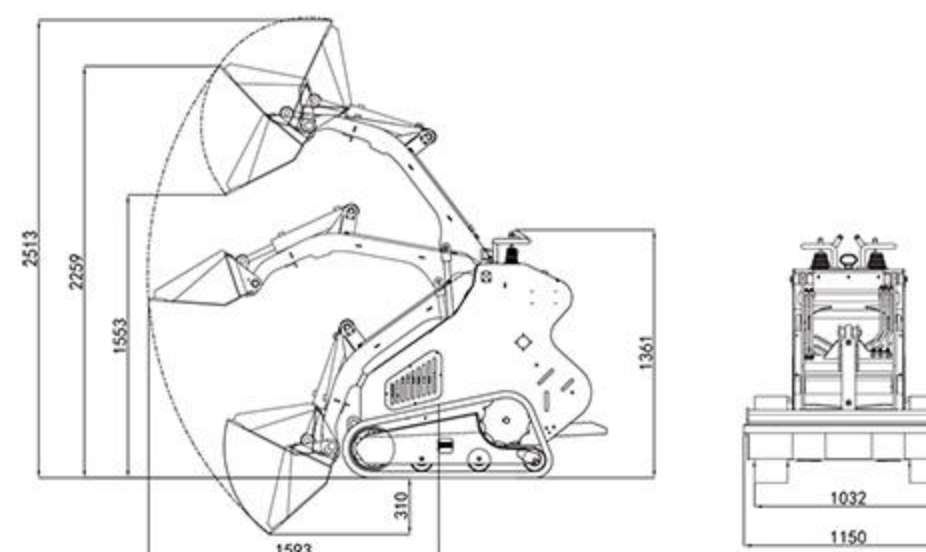

- The compact design allows it to operate in a small space, making it suitable for urban infrastructure construction.
- It can quickly replace a variety of attachments, making it a multi-purpose machine, greatly improving work efficiency.
- It can achieve on-site steering, making it particularly suitable for operating in narrow or confined spaces.
- With its powerful power and flexible operation, it can quickly complete various tasks.
- It has a special maintenance port for easy maintenance

DETAIL DISPLAY



B&S Engines

Powerful and reliable performance in all working conditions.



Triple gear pump system

(36+18+18 L/min) ensures efficient distribution, precise control, and smooth operation.



Five auxiliary oil circuits

The oil circuit layout is reasonable to meet the needs of various attachments and improve operating efficiency.



Universal quick-change interface

Compatible with mainstream auxiliary tools on the market, quick switching can be completed in 30 seconds to improve work efficiency.

STRUCTURAL PARAMETERS

Machine operating weight	725kg	1598lb
Bucket capacity	0.15m ³	5.3ft ³
Rated load mass (safe load)	140kg	309lb
Maximum load mass	280kg	617lb
Maximum unloading height	1553mm	45.4in
Maximum loading height	2259mm	90in
Maximum unloading distance	620mm	24.4in
Minimum ground clearance	129mm	5.1in
Transport length - with bucket	2100mm	82.7in
Transport length - without bucket	1638mm	64.5in
Transport width	1150mm	45.3in
Transport height	1361mm	53.6in
Bucket width	1150mm	45.3in
Engine brand	RATO	RATO
Engine model	R420	R420
Maximum power	8.6Kw	11.5hp
Maximum speed	3600rpm	3600rpm
Number of cylinders	1	1



SKID STEER

RS04

SKID STEER LOADER



HIGHLIGHTING ADVANTAGES

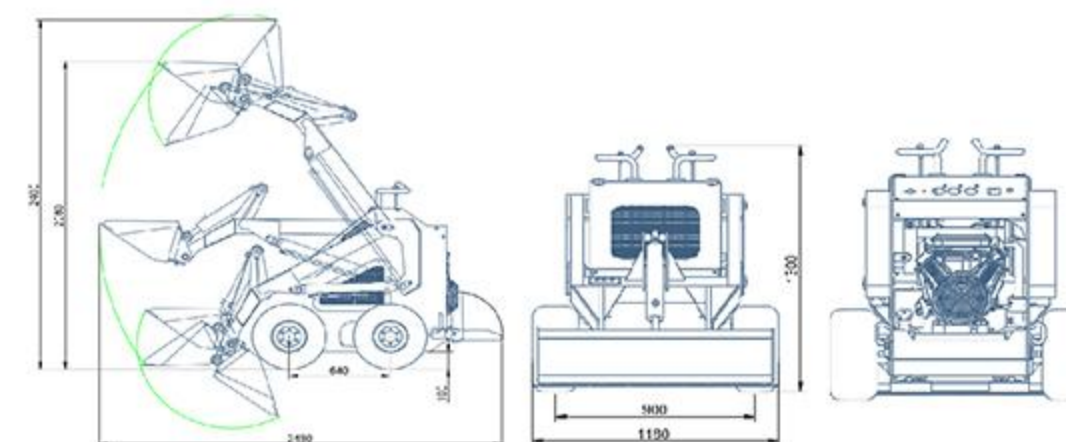

- The compact design allows it to operate in a small space, making it suitable for urban infrastructure construction.
- It can quickly replace a variety of attachments, making it a multi-purpose machine, greatly improving work efficiency.
- It can achieve on-site steering, making it particularly suitable for operating in narrow or confined spaces.
- With its powerful power and flexible operation, it can quickly complete various tasks.
- It has a special maintenance port for easy maintenance

DETAIL DISPLAY



Kubota Engines

Powerful and reliable performance in all working conditions.



Triple gear pump system

(36+18+18 L/min) ensures efficient distribution, precise control, and smooth operation.



Five auxiliary oil circuits

The oil circuit layout is reasonable to meet the needs of various attachments and improve operating efficiency.



Modular Mobility System

15-Minute Track/Wheel Conversion for All-Terrain Dominance

STRUCTURAL PARAMETERS

Machine operating weight	890kg	1958lb
Bucket capacity	0.15m ³	5.3ft ³
Rated load mass (safe load)	175kg	386lb
Maximum load mass	400kg	880lb
Maximum unloading height	1553mm	45.4in
Maximum loading height	2080mm	81.9in
Maximum unloading distance	550mm	21.7in
Minimum ground clearance	108mm	4.3in
Transport length - with bucket	1970mm	77.6in
Transport length - without bucket	1520mm	59.8in
Transport width	1150mm	45.3in
Transport height	1300mm	51.2in
Bucket width	1150mm	45.3in
Engine brand	kubota	kubota
Engine model	Z482	Z482
Maximum power	8.3Kw	11.1hp
Maximum speed	3000rpm	3000rpm
Number of cylinders	2	2



SKID STEER

RS06

SKID STEER LOADER



HIGHLIGHTING ADVANTAGES

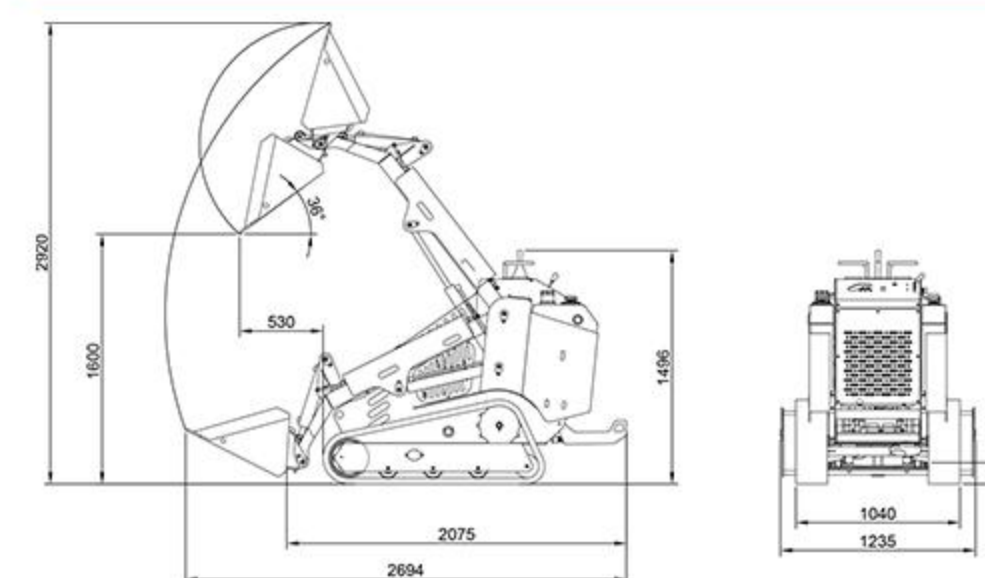

- The whole machine is small in size and strong in maneuverability
- In-situ steering can be achieved, making it easier to shuttle around crowded construction sites and construction sites;
- Enlarged and thickened bucket, not easy to corrode and rust, can quickly replace auxiliary tools, widely used and easy to operate;
- Big factory brand engine, strong power, stable operation, time-saving and labor-saving;
- The skid steer loader can be lifted to a high place with a crane, such as when building a building.

DETAIL DISPLAY



Kubota Engines

Delivering strong power, stable performance, low noise, and fuel efficiency for versatile job applications.



High-efficiency piston pump

Providing stable high-pressure power output for precise control and outstanding performance in demanding work environments.



Load-sensing multi-way valve

Ensuring precise flow control and efficient power transmission, adapting to varying load conditions, and enhancing work efficiency and stability.



3 auxiliary oil circuits

enabling quick connection of various attachments to enhance job flexibility and operational efficiency.

STRUCTURAL PARAMETERS

Machine operating weight	1201kg	2642lb
Bucket capacity	0.2m ³	7.1ft ³
Rated load mass (safe load)	325kg	715lb
Maximum load mass	650kg	1430lb
Maximum unloading height	1600mm	63in
Maximum loading height	2580mm	101.6in
Maximum unloading distance	586mm	23.1in
Minimum ground clearance	176mm	6.9in
Transport length - with bucket	2792mm	109.9in
Transport length - without bucket	2150mm	84.6in
Transport width	1150mm	45.3in
Transport height	1522mm	59.9in
Bucket width	1150mm	45.3in
Engine brand	kubota	kubota
Engine model	D1105	D1105
Maximum power	18.4KW	24.7hp
Maximum speed	3000rpm	3000rpm
Number of cylinders	3	3



SKID STEER

RS07

SKID STEER LOADER



HIGHLIGHTING ADVANTAGES

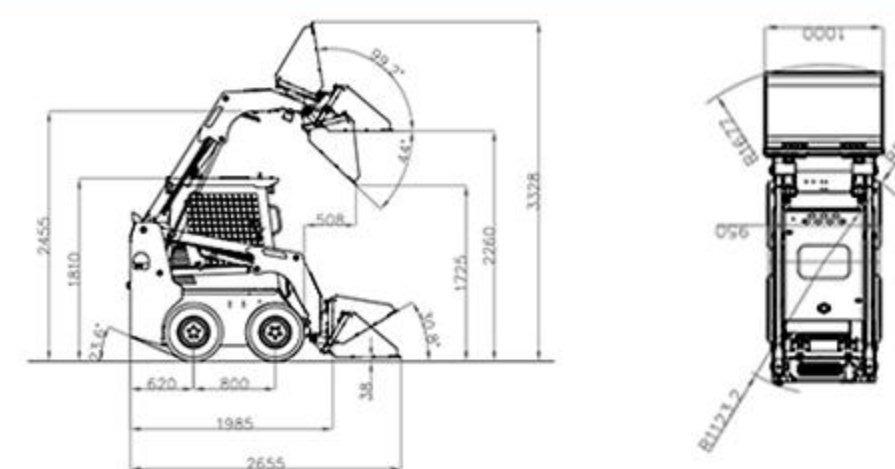

- The lifting arm adopts cast steel profiles to improve material strength and stiffness. Appropriate areas also have thinner contours to improve visibility.
- Compact tracked loaders with high buoyancy and traction, and low ground pressure are heavier and can provide maximum thrust.
- The loader has a compact and flexible structure, capable of 360 degree rotation and easy operation at close range, bringing responsive and well-balanced turns to the work site.
- The design of the integrated sealed pressurized cab provides a nearly seamless interior, while the more spacious design provides a sealed and pressurized environment, minimizing dust and dirt in the cab.
- Equipped with a Yangma engine. Low fuel consumption, low vibration, low noise, and environmental considerations have all reached a high level.

DETAIL DISPLAY



kubota Engines

Delivering strong power, stable performance, low noise, and fuel efficiency for versatile job applications.



Pilot operation

2 double closed pumps, built-in oil replenishment pump and gear pump, reasonable power distribution, efficient and stable operation.



Pilot operation

The control is sensitive and precise, and the response is quick, ensuring an efficient working experience.



Universal quick-change interface

Compatible with mainstream auxiliary tools on the market, quick switching can be completed in 30 seconds to improve work efficiency.

STRUCTURAL PARAMETERS

Machine operating weight	1230kg	2706lb
Bucket capacity	0.16m ³	5.7ft ³
Rated load mass (safe load)	300kg	661lb
Maximum load mass	670kg	1477lb
Maximum unloading height	1725mm	68in
Maximum loading height	2260mm	89in
Maximum unloading distance	508mm	20in
Minimum ground clearance	176mm	6.9in
Transport length - with bucket	2655mm	105in
Transport length - without bucket	1985mm	78.1in
Transport width	1000mm	39.4in
Transport height	1810mm	71.3in
Bucket width	1000mm	39.4in
Engine brand	kubota	kubota
Engine model	D1105	D1105
Maximum power	18.4KW	24.7hp
Maximum speed	3000rpm	3000rpm
Number of cylinders	3	3



SKID STEER

RS20

SKID STEER LOADER



HIGHLIGHTING ADVANTAGES

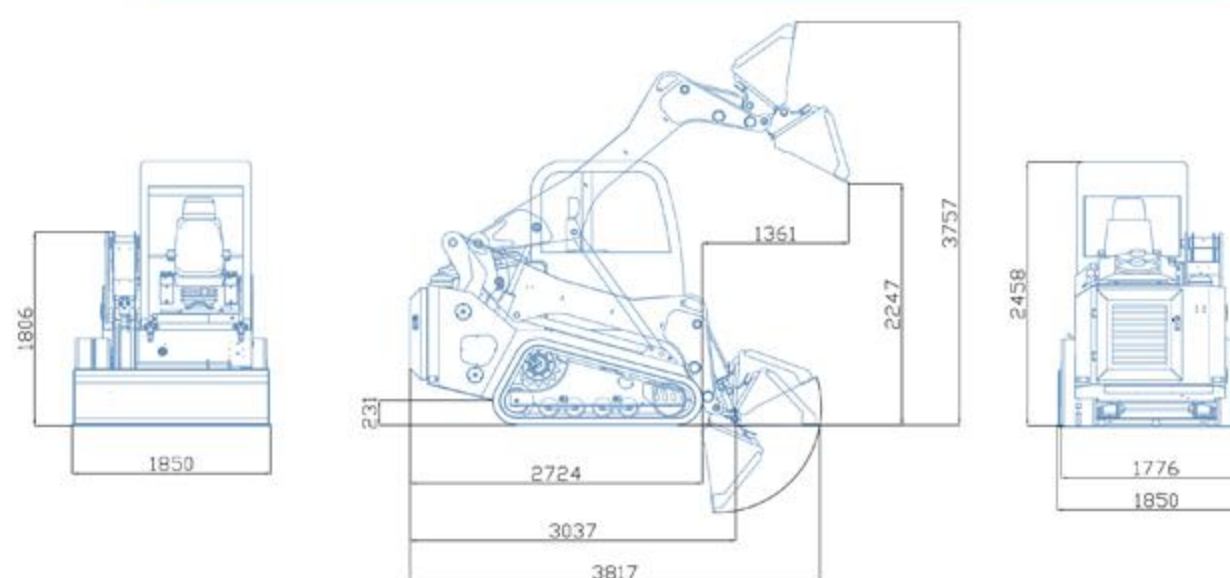

- The cab can be lifted hydraulically, and the square-sided inspection pipeline facilitates maintenance.
- In-situ steering can be achieved, making it easier to shuttle around crowded construction sites and construction sites;
- Enlarged and thickened bucket, not easy to corrode and rust, can quickly replace auxiliary tools, widely used and easy to operate;
- Big brand engine, strong power, stable operation, time-saving and labor-saving;
- The skid steer loader can be lifted to a high place with a crane, such as when building a building.

DETAIL DISPLAY



Yanmar Engines

Delivering powerful output with lower fuel consumption, ensuring reliable performance across demanding job sites.



Four-pump hydraulic system

Two tandem closed-loop pumps, an internal charge pump, and a gear pump, ensuring efficient power distribution and smooth, stable operation.



Load-sensing multi-way valve

Ensuring precise flow control and efficient power transmission, adapting to varying load conditions, and enhancing work efficiency and stability.



Side-entry spacious cab design

It is more convenient for operators to enter and exit, while the panoramic protection design ensures comprehensive safety and improves the comfort and safety during operation.

STRUCTURAL PARAMETERS

Machine operating weight	4225kg	9295lb
Bucket capacity	0.4m ³	14.1ft ³
Rated load mass (safe load)	1050kg	2310lb
Maximum load mass	2100kg	4620lb
Maximum unloading height	2250mm	88.6in
Maximum loading height	3750mm	147.6in
Maximum unloading distance	1360mm	53.5in
Minimum ground clearance	230mm	9.1in
Transport length - with bucket	3820mm	150.4in
Transport length - without bucket	3040mm	119.7in
Transport width	1850mm	72.8in
Transport height	2460mm	96.9in
Bucket width	1850mm	72.8in
Engine brand	Yanmar	Yanmar
Engine model	4TNV98C-PLYS	4TNV98C-PLYS
Maximum power	49.9KW	66.9hp
Maximum speed	2400rpm	2400rpm
Number of cylinders	4	4